

NAUTIKA



1. Lanac DIN764, svijetli ili toplo cinčani

Chain DIN764



nazivni promjer mm	korak karike mm	širina karike		dopuštena nosivost kN max.	težina lanca ≈ kg/m
		unutarnja b ₁ min.	vanjska b ₂ max.		
10	35	14	36	10	2
13	45	18	47	16	3,5
16	56	22	58	25	5,2
18	63	24	65	32	6,5
20	70	27	72	40	8,2
23	80	31	83	50	11
26	91	35	94	63	14
28	98	36	101	75	16,5
30	105	39	108	85	19

2. Lanac DIN 766, kvalitete 3, inox ili toplo cinčani

Chain DIN766



nazivni promjer mm	korak karike mm	širina karike		dopuštena nosivost kN max.	težina lanca ≈ kg/m
		unutarnja b ₁ min.	vanjska b ₂ max.		
4	16	4,8	13,6	200	0,32
5	18,5	6	17	320	0,5
6	18,5	7,2	20,4	400	0,8
7	22	8,4	23,8	630	1,1
8	24	9,6	27,2	800	1,4
10	28	12	36	1250	2,3
11	31	13,2	40	1600	2,7
13	36	15,6	47	2000	3,9
16	45	19,2	58	3200	5,8
18	50	21,6	65	4000	7,4

3. Lanac za sidrenje pomorskih oznaka DIN 5683, svijetli ili toplo cinčani

Chain DIN5683- I - 1964.



nazivni promjer mm	korak karike mm	širina karike b ₂ mm	opterećenje		težina lanca kg/m
			ispitno kN	prekidno kN	
16	144	88	15	75	4,3
18	162	99	18,3	91,5	5,5
20	180	110	22,8	114	6,6
23	207	127	30	150	8,9
26	234	143	38,4	192	11,4
30	270	165	51	255	15,2
33	297	181	61,8	309	18,3
36	324	198	75	375	21,9

4. Karabiner vatrogasni s okom i s maticom INOX

Selflocking eye carabine hook with coil

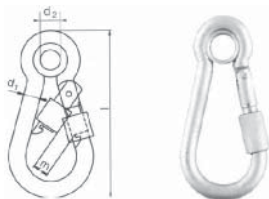

br. artikla	oznaka	dimenzije prema slici(mm)				nosivost
		d ₁	d ₂	l	m	
92006063	60 x 6	60	6	8	7	0,120
92008083	80 x 8	80	8	12	9	0,230
92010012	100 x 10	100	10	15	11	0,350
92012013	120 x 13	120	11	18	16	0,450

5. Brza spojnica INOX

Quick link

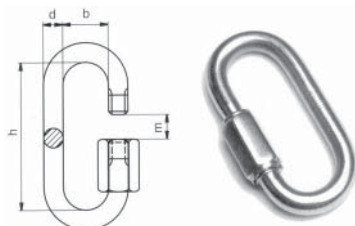

br. artikla	dimenzije prema slici(mm)				nosivost
	b	d	h	m	
93100035	10	3,5	29	5,0	0,050
93100040	12	4,0	32	5,5	0,090
93100050	13	5,0	39	6,5	0,140
93100060	14	6,0	45	7,5	0,200
93100070	16	7,0	52	8,5	0,275
93100080	18	8,0	58	10,0	0,350
93100090	19	9,0	62	11,0	0,450
93100100	22	10,0	69	12,0	0,550
93100120	24	12,0	81	15,0	0,750

6. Jezgra užeta INOX

Stainless steel thimble

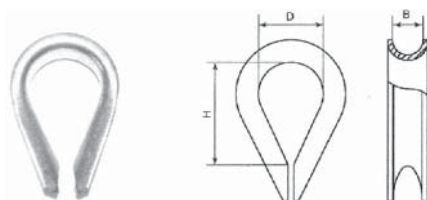

br. artikla	veličina (mm)	težina (kg/100kom.)	br. artikla	veličina (mm)	težina (kg/100kom.)
RL16-1201	3	0.38	RL15-1208	14	10.30
RL16-1202	4	0.53	RL15-1209	16	12.40
RL16-1203	5	0.70	RL15-1210	20	26.60
RL16-1204	6	0.96	RL15-1211	22	32.60
RL16-1205	8	2.05	RL15-1212	24	45.10
RL16-1206	10	3.30	RL15-1213	28	73.90
RL16-1207	12	5.50			

7. Škopac INOX

DEE Shackle

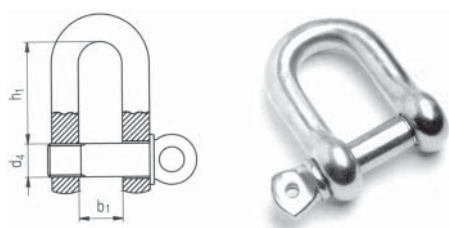

br. artikla	dimenzije prema slici(mm)			nosivost
	d ₄	b ₁	h ₁	
90018109	M 4	8	16	0,160
90029109	M 5	10	19	0,250
90030109	M 6	12	24	0,375
90031109	M 8	16	32	0,625
90032109	M10	20	40	1,000
90034109	M12	25	48	1,500
90035109	M16	32	64	2,750
90035209	M20	38	76	3,750
90035209	M22	44	88	4,750
90035309	M24	50	100	5,750

8. Škopac trbušasti INOX BOW shackle

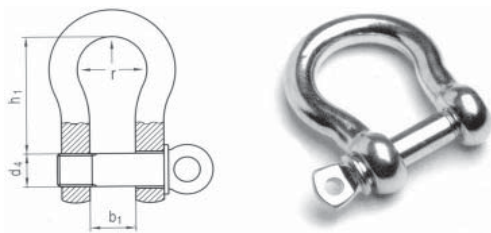

br. artikla	dimenzije prema slici(mm)				nosivost t
	d ₁	b ₁	r	h ₁	
90036108	M 4	8	12	16	0,160
90036109	M 5	10	15	20	0,250
90037109	M 6	12	18	24	0,375
90038110	M 8	16	24	32	0,625
90039110	M 10	20	30	40	1,000
90039120	M 12	25	36	48	1,500
90039160	M 16	32	48	64	2,750
90039200	M 20	38	60	80	3,750
90039220	M 22	44	66	88	4,750
90039240	M 24	50	75	100	5,750

9. Škopac izduženi D INOX Long dee shackle



br. artikla	veličina (inch)	nosivost (kg)	I.L. (inch)	težina (kg)
RL16-2001	5/32	90	1-3/16	0.010
RL16-2002	3/16	100	1-1/2	0.020
RL16-2003	1/4	150	1-3/4	0.036
RL16-2004	5/16	250	2-3/8	0.083
RL16-2005	3/8	500	3	0.164
RL16-2006	1/2	600	3-1/2	0.280

10. Škopac uvijeni INOX Twist shackle



br. artikla	veličina (inch)	nosivost (kg)	O.L. (inch)	težina (kg)
RL16-2101	5/32	90	1-1/32	0.017
RL16-2102	3/16	100	1-1/4	0.020
RL16-2103	1/4	150	1-9/16	0.034
RL16-2104	5/16	250	1-7/8	0.080
RL16-2105	3/8	500	2-7/16	0.150
RL16-2106	1/2	600	2-7/8	0.240

11. Škopac C INOX C shackle



br. artikla	veličina (mm)	nosivost (kg)	I.L. (mm)	N.W. (mm)	težina (kg)
RL16-2201	8	250	38	30	0.11
RL16-2202	9	450	45	36	0.30
RL16-2203	12	600	54	55	0.60

12. Stezaljka užeta INOX

Wire rope clip

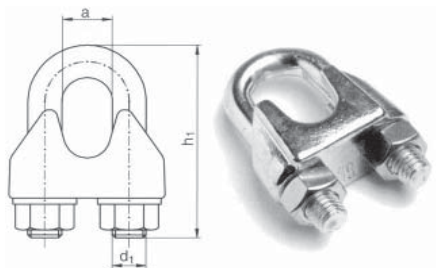

br. artikla	promjer užeta (mm)	dimenzije prema slici (mm)		
		d ₁	h ₁	a
90793602	2,0	M 3	17	4
90793603	3,0	M 4	20	5
90793604	4,0	M 4	22	6
90793605	5,0	M 5	24	6
90793606	6,0	M 5	28	8
90793608	8,0	M 6	34	10
90793610	10,0	M 8	42	12
90793612	12,0	M10	55	15
90793616	16,0	M12	63	18
90793619	19,0	M12	75	21
90793622	22,0	M14	85	24
90793624	24,0	M14	95	27

13. Vijak U INOX

U-bolt



br. artikla	veličina (mm)	O.L. (mm)	dužina navoja (mm)	težina (kg/100 kom)
RL16-6201	4	64	30	1,80
RL16-6202	5	80	40	3,20
RL16-6203	6	80	40	4,80
RL16-6204	8	60	25	6,40
RL16-6205	8	70	35	7,00
RL16-6206	8	80	40	7,50
RL16-6207	8	90	50	8,00
RL16-6208	8	100	50	8,60
RL16-6209	8	110	70	9,00
RL16-6210	10	90	40	18,60
RL16-6211	10	130	55	20,30
RL16-6212	12	150	65	35,50

14. Zatezalo cjevasto VIL/VIL INOX

Rigging screw Jaw/Jaw

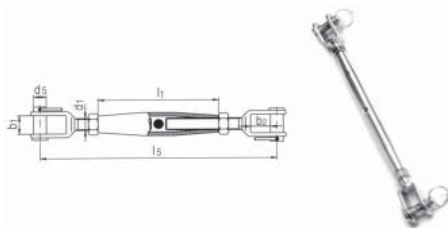

br. artikla	dimenzije prema slici (mm)						nosivost t
	d ₁	l ₁	d ₅	b ₁	b ₂	l ₅	
90092005	M 5	80	5	6	9	130-190	0,187
90093006	M 6	95	6	8	10	150-220	0,275
90094008	M 8	105	8	10	11	180-255	0,500
90095010	M 10	125	9	12	13	220-300	0,775
90096012	M 12	150	12	14	20	270-385	1,125
90097014	M 14	165	12	14	22	300-425	1,500
90098016	M 16	190	16	16	26	360-500	2,050
90099020	M 20	210	19	20	30	390-560	3,200

15. Zatezalo cjevasto VIL/KLEMA INOX

Rigging screw Jaw/Terminal

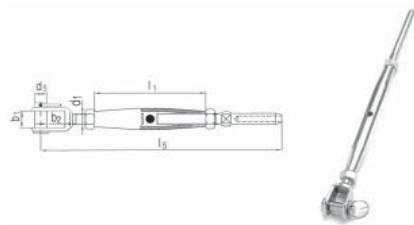

br. artikla	primjer užeta (mm)	dimenzije prema slici (mm)					nosivost t	
		d ₁	l ₁	d ₅	b ₁	b ₂		
90082005	2,5	M 5	80	5	6	9	130-190	0,187
90083006	3,0	M 6	95	6	8	10	150-220	0,275
90084008	4,0	M 8	105	8	10	11	280-255	0,500
90085010	5,0	M 10	125	9	12	13	220-300	0,775
90086012	6,0	M 12	150	12	14	20	270-385	1,125
90087014	7,0	M 14	165	12	14	22	300-425	1,500
90088016	8,0	M 16	190	16	16	26	360-500	2,050
90089020	10,0	M 20	210	19	20	30	390-560	3,200

16. Zatezalo VIL/KLEMA INOX
Jaw Terminal

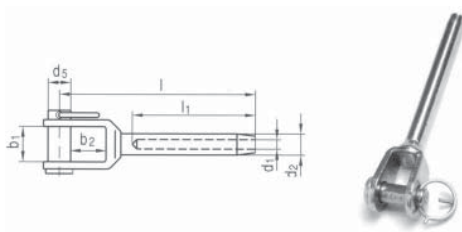

br. artikla	promjer užeta (mm)	dimenzije prema slici(mm)					
		l	l ₁	l ₂	d ₂	d ₁	g
90120005	2,5	70	38	24	5,45	2,70	M 5
90121006	3,0	80	40	32	6,35	3,00	M 6
90121007	4,0	95	44	40	7,50	4,20	M 6
90122008	4,0	102	52	40	7,50	4,20	M 8
90122009	5,0	120	52	57	9,00	5,15	M 8
90123010	5,0	130	63	57	9,00	5,15	M 10
90123910	6,0	136	63	63	12,50	6,75	M 10
90124012	6,0	142	68	63	12,50	6,75	M 12
90126016	8,0	175	89	76	16,10	8,35	M 16

17. Priključak s okom INOX
Eye-terminal

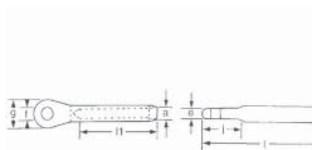

br. artikla	promjer užeta (mm)	dimenzije prema slici(mm)								
		l	l ₁	a	c	e	f	g	j	k
90135030	3,0	64	36	3,2	6,5	4	6,5	13	19,5	5,2
90136040	4,0	74	39	4,2	7,5	6	8,0	18	25,6	6,5
90137050	5,0	91	50	5,2	9,0	7	10,0	22	30,0	7,5
90138060	6,0	108	62	6,2	12,5	8	12,5	28	40,0	10,0
90140070	7,0	119	68	7,2	14,0	9	12,7	28	40,0	10,5
90141080	8,0	140	85	8,2	16,0	10	14,5	32	44,0	13,0
90142100	10,0	160	90	10,2	17,5	12	16,4	36	50,0	14,8

18. Vijak natezni INOX
Turnbuckle

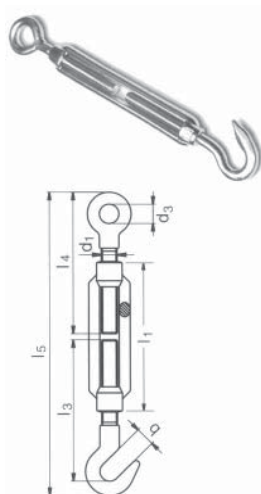

kuka-oko

hook-eye

br. artikla	dimenzije prema slici(mm)							oznaka
	d ₁	l ₁	d ₃	b	l ₃	l ₄	l ₅	
91011300	M 5	70	8	9	53	58	120-165	45
91011400	M 6	110	10	10	85	80	172-252	80
91025160	M 8	110	11	11	85	84	182-257	75
91033800	M10	125	12	12	112	105	213-298	85
91041200	M12	125	14	14	117	115	238-318	80
91055800	M16	170	16	16	138	165	320-430	110

kuka-kuka

hook-hook

br. artikla	dimenzije prema slici(mm)				
	d ₁	l ₁	b	l ₃	l ₅
91011302	M 5	70	9	53	120-165
91011402	M 6	110	10	85	180-260
91025162	M 8	110	11	85	195-270
91033802	M10	125	12	112	230-315
91041202	M12	125	14	117	250-230
91055802	M16	170	16	138	320-430

oko-oko

eye-eye

br. artikla	dimenzije prema slici(mm)				
	d ₁	l ₁	d ₃	l ₄	l ₅
91011301	M 5	70	8	58	120-165
91011401	M 6	110	10	80	167-247
91025161	M 8	110	11	84	179-254
91033801	M10	125	12	105	210-295
91041201	M12	125	14	115	230-310
91055801	M16	170	16	165	330-440

19. Vijak okasti DIN 580 INOX

Eye coil DIN580

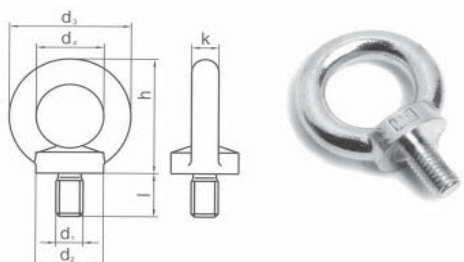

A4 / AISI 316



br. artikla	dimenzije prema slici(mm)							nosivost
	d ₁	l	d ₂	d ₃	d ₄	h	k	
92300064	M 6	13,0	20	36	20	36	8	0,070
92300084	M 8	13,0	20	36	20	36	8	0,140
92300104	M10	17,0	25	45	25	45	10	0,230
92300124	M12	20,5	30	54	30	53	12	0,340
92300164	M16	27,0	35	63	35	62	14	0,700
92300204	M20	30,0	40	72	40	71	16	1,200
92300244	M24	36,0	50	90	50	90	20	1,800

20. Matica okasta DIN 582 INOX

Eye nut DIN582

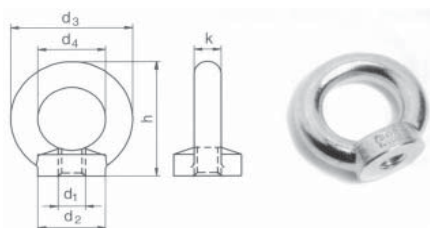

A4 / AISI 316



br. artikla	dimenzije prema slici(mm)						nosivost
	d ₁	d ₂	d ₃	d ₄	h	k	
92400060	M 6	20	36	20	36	8	0,070
92400080	M 8	20	36	20	36	8	0,140
92400100	M10	25	45	25	45	10	0,230
92400120	M12	30	54	30	53	12	0,340
92400160	M16	35	63	35	62	14	0,700
92400200	M20	40	72	40	71	16	1,200
92400240	M24	50	90	50	90	20	1,800

21. Vrtuljak OKO/OKO INOX

Swivel eye-eye

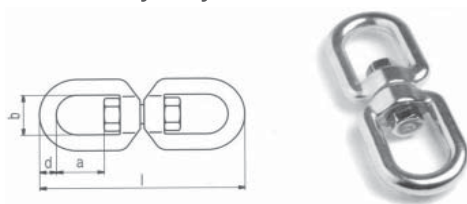

br. artikla	dimenzije prema slici(mm)				nosivost
	d	a	b	l	
90240005	5	13	13	60	0,170
90240006	6	15	15	65	0,250
90240008	8	22	20	90	0,650
90240010	10	27	24	115	1,000
90240013	13	32	32	154	1,400
90240016	16	42	39	188	2,500



22. Vrtuljak ŠKOPAC/ŠKOPAC INOX

Swivel shackle-shackle

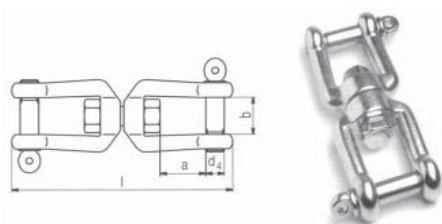

br. artikla	dimenzije prema slici(mm)				nosivost
	d ₄	a	b	l	
90260006	M 6	11	12	66	0,250
90260008	M 8	16	16	94	0,650
90260010	M10	22	20	118	1,000
90260013	M12	28	26	152	1,400
90260016	M16	37	32	188	2,500



23. Vrtuljak OKO/ŠKOPAC INOX

Swivel eye-shackle

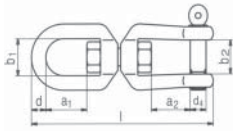

br. artikla	dimenzije prema slici(mm)							nosivost
	d ₄	d	a ₁	a ₂	b ₁	b ₂	l	
90250006	M 6	6	15	11	15	12	66	0,250
90250008	M 8	8	22	16	20	16	94	0,650
90250010	M 10	10	27	22	24	20	118	1,000
90250013	M 12	13	32	28	32	26	152	1,400
90250016	M 16	16	42	37	39	32	188	2,500

24 Škopac OKO/VILICA INOX

Toggles

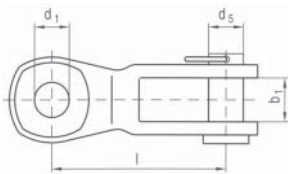

br. artikla	dimenzije prema slici(mm)			
	l	d	d _s	b ₁
90084005	22	5,5	5,5	6
90085006	27	6,5	6,5	7
90056008	31	8,5	8,5	10
90087010	36	10,0	10,0	12
90089012	50	13,0	13,0	13
90090016	60	13,0	15,0	15
90091020	80	16,5	16,5	17

25. Prsten INOX

Round ring



br. artikla	veličina (mm)	I.D. (mm)	težina (kg/100kom.)	br. artikla	veličina (mm)	I.D. (mm)	težina (kg/100kom.)
RL16-2601	3	20	0.41	RL15-2628	8	70	9.44
RL16-2602	3	25	0.50	RL15-2629	8	75	9.86
RL16-2603	3	30	0.59	RL15-2630	8	80	10.24
RL16-2604	4	25	0.91	RL15-2631	9	50	10.49
RL16-2605	4	30	1.07	RL15-2632	9	55	11.04
RL16-2606	4	35	1.23	RL15-2633	9	60	11.12
RL16-2607	4	40	1.39	RL15-2634	9	70	12.63
RL16-2608	5	25	1.48	RL15-2635	10	50	11.85
RL16-2609	5	30	1.73	RL15-2636	10	55	12.83
RL16-2610	5	35	1.98	RL15-2637	10	60	13.82
RJ16-2611	5	40	2.23	RL15-2638	10	65	14.53
RL16-2612	5	45	2.47	RL15-2639	10	70	15.80
RL16-2613	5	50	2.58	RL15-2640	10	80	17.80
RL16-2641	6	25	2.16	RL15-2641	10	90	19.80
RL16-2615	6	30	2.72	RL15-2642	10	100	21.70
RL16-2616	6	35	2.92	RL15-2643	12	60	20.50
RL16-2617	6	40	3.27	RL15-2644	12	70	23.30
RL16-2618	6	45	3.63	RL15-2645	12	80	26.20
RL16-2619	6	50	3.99	RL15-2646	12	90	29.00
RL16-2620	6	55	4.34	RL15-2647	12	100	31.80
RL16-2621	6	60	4.69	RL15-2648	13	60	24.40
RL16-2622	8	40	6.06	RL15-2649	13	70	27.70
RL16-2623	8	45	6.69	RL15-2650	13	80	31.00
RL16-2624	8	50	7.32	RL15-2651	13	90	34.40
RL16-2625	8	55	7.96	RL15-2652	13	100	37.70
RL16-2626	8	60	8.58	RL15-2653	13	110	41.00
RL16-2627	8	65	9.23	RL15-2654	13	120	44.40

26. Sidro tip B Fold Anchor Type B



br. artikla	težina (kg.)	br. artikla	težina (kg.)
RL12-0301	0.7	RL12-0304	3.5
RL12-0302	1.4	RL12-0305	5.5
RL12-0303	2.3	RL12-0306	7.5

27. Sidro Bruce INOX Stainless Steel Bruce Anchor



br. artikla	težina (kg.)	br. artikla	težina (kg.)
RL16-4101	2.0	RL16-4105	10.0
RL16-4102	3.0	RL16-4106	15.0
RL16-4103	5.0	RL16-4107	20.0
RL16-4104	7.5		

28. Sidro preklopno INOX Stainless Steel Folding Anchor



br. artikla	težina (kg.)	br. artikla	težina (kg.)
RL16-4201	0.75	RL16-4204	4.00
RL16-4202	1.50	RL16-4205	5.00
RL16-4203	2.50	RL16-4206	6.00

29. Ublaživač udaraca INOX Stainless steel anchor line shock absorber



br. artikla	veličina (mm)	težina (kg/100kom.)
RL16-6401	3	5.75
RL16-6402	4	13.15

30. Klin INOX Stainless Steel Cleat



br. artikla	veličina (inch)	dužina (inch)	visina (inch)	težina (kg)
RL16-6501	5	1-1/2	1-1/8	0.14
RL16-6502	6	1-7/8	1-1/4	0.21
RL16-6503	8	2-3/16	1-5/8	0.42
RL16-6504	10	2-11/16	1-7/8	0.64
RL16-6505	12	2-3/4	2-3/16	0.95

31. Kuka za skraćivanje s vilicom INOX*Stainless Steel Clevis Grab Hook*

br. artikla	lanac (inch)	nosivost (kg)	I.L. (inch)	težina (lbs)
RL16-5601	1/4	1250	1.79	0.37
RL16-5602	5/16	1800	2.14	0.64
RL16-5603	3/8	2500	2.46	0.90
RL16-5604	1/2	3600	3.20	1.94

32. Kuka s osiguralom i vilicom INOX*Stainless Steel Clevis Slip Hook with Latch*

br. artikla	lanac (inch)	nosivost (kg)	I.L. (inch)	težina (lbs)
RL16-5701	1/4	950	2.56	0.42
RL16-5702	5/16	1250	2.70	0.77
RL16-5703	3/8	2000	3.20	1.17
RL16-5704	1/2	3000	4.00	2.34

33. Kuka za skraćivanje s okom INOX*Stainless steel eye grab hook*

br. artikla	lanac (inch)	nosivost (kg)	I.L. (inch)	težina (lbs)
RL16-5801	1/4	1250	2.50	0.28
RL16-5802	5/16	1800	2.78	0.51
RL16-5803	3/8	2500	3.23	0.76
RL16-5804	1/2	3600	4.10	1.60

34. Kuka s osiguralom i okom INOX*Stainless steel eye Slip Hook with Latch*

br. artikla	lanac (inch)	nosivost (kg)	I.L. (inch)	težina (lbs)
RL16-5901	1/4	950	2.60	0.35
RL16-5902	5/16	1250	2.90	0.55
RL16-5903	3/8	2000	3.40	0.92
RL16-5904	1/2	3000	4.25	1.90

35. Kuka s osiguralom i okom za dizanje INOX*Stainless steel eye Slip Hook with Latch*

br. artikla	veličina (t)	težina (kg)
RL16-6001	1/2	0.22
RL16-6002	3/4	0.35
RL16-6003	1	0.45
RL16-6004	1-1/2	0.69
RL16-6005	2	0.90
RL16-6006	3	1.68